

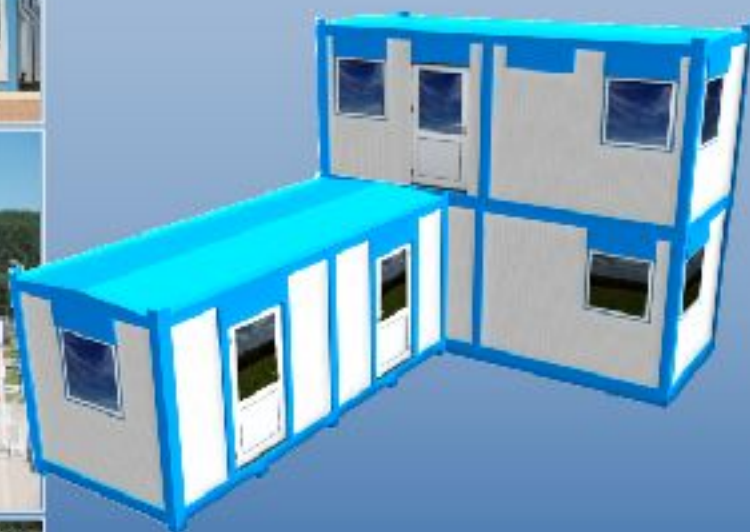

Accomodation Containers

For site organization



"CONFIND" CONTAINERIZED MODULES

The **CONFIND** containerized modules are intended for site organization in various fields of activity: civil and industrial construction, roads and bridges, oil and gas fields. The modules are produced in various construction alternatives and sizes allowing railroad or road transportation. Stationary or mobile (mounted on road trailer chassis), the containerized modules can be employed for a great variety of uses: offices, conference halls, mess halls, locker rooms, sleeping rooms, sanitary facilities, storage facilities, shops, snack-bars, thermal stations, housing for various technologic installations etc. With the possibility of being assembled one on top of another or in groups of 2 up to 12, with or without interior partitions, these modern modules produced by **CONFIND** always satisfy the requirements of the clients.

THE "CONFIND" STANDARD MODULE



The strain bearing structure is made of a metal skeleton of rolled profiles and cold drawn steel plate, assembled by welding or screws.

The outer walls are made of sandwich panels (scaled steel plates with polyurethane injected inside), of the types Ondatherm, Isopan or Oltpan, with a standard thickness of 40 mm, and, optionally, thicknesses up to 100 mm.

The floor is made of resinous planks covered in linoleum or wall-to-wall carpeting. Optionally, serrated plate can be used, thermally insulated with special products.

The protective roof is made of scaled steel plate 1.25 mm thick.

The carpentry elements and all outer joints are **sealed** with weather proof

The frames for the door and two windows provided for the standard containerized modules are made of aluminum or PVC profiles imported from Italy and the panes are thermopan, reinforced or break-proof. On request, the windows can be provided with horizontal aluminum blinda and/or protected with metal bars.

Standard electrical equipment. The modules are provided with 220 V electric installation, for interior lighting and two wall sockets.

Anti-rust protection is provided by sandblasting, priming and painting for the metal structure, while the outer walls and roof are painted in an electrostatic field.

Heating elements are provided **optionally**.



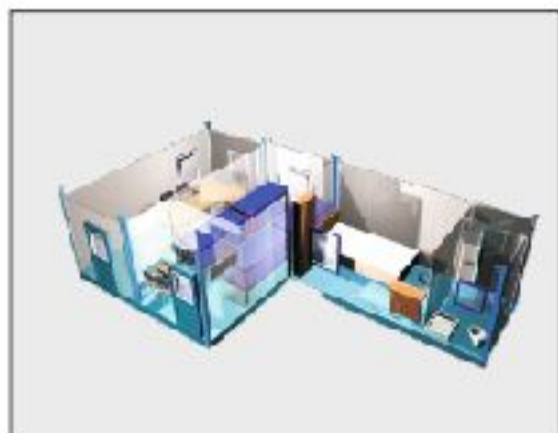
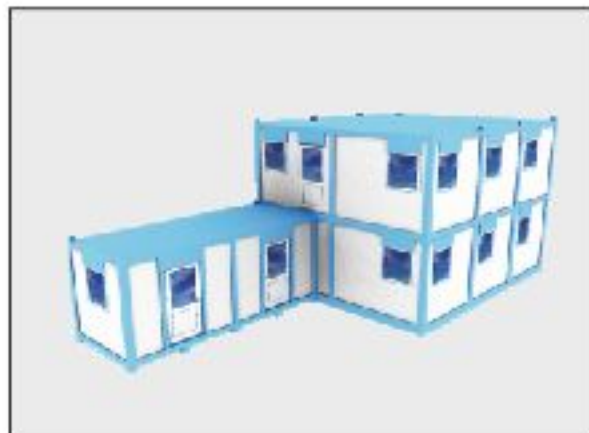

Standard dimensions (according to ISO 9001 Standard) are 10 ft and 20 ft:

Dimensions			
Length:	6000mm	9350mm	12000mm
Width:	2400mm	2650mm	3500mm
Height:	2600mm	2600mm	2600mm

Specific weight reported on the surface of the module is 125 kg/sqm

Range of options

Office

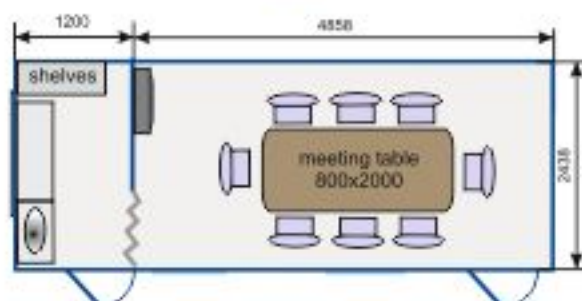

Dormitory (4-6-8 persons)

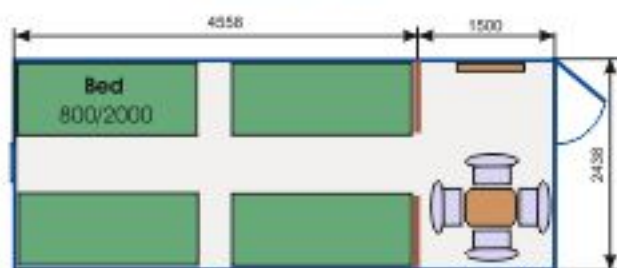

Cantines

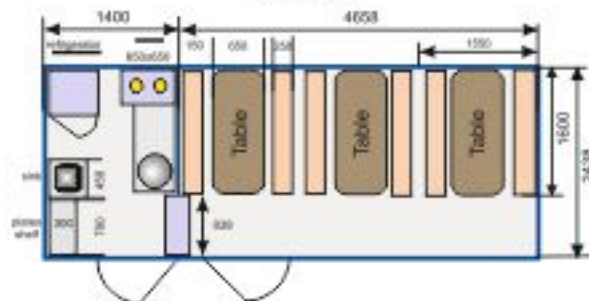

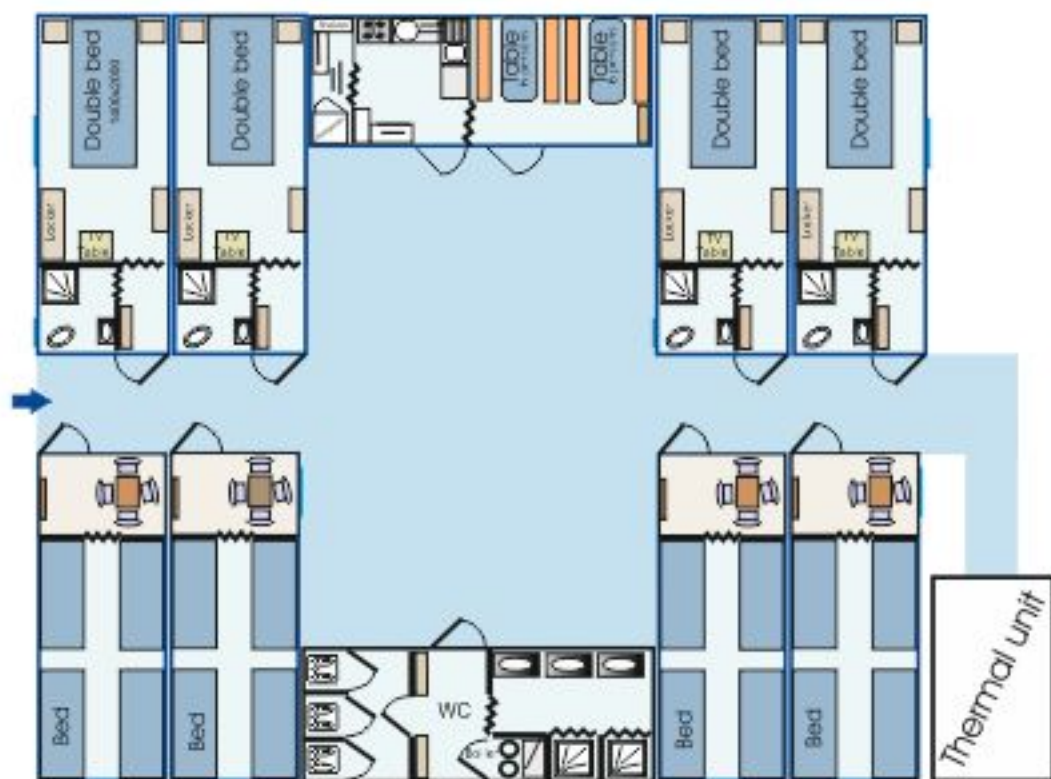
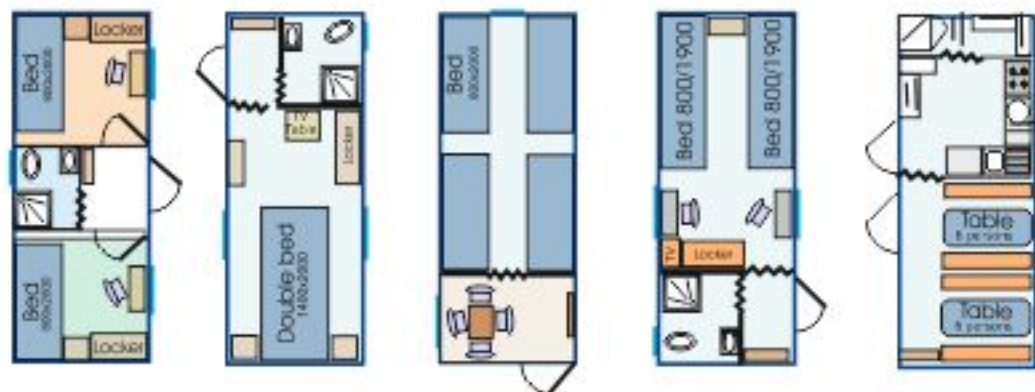
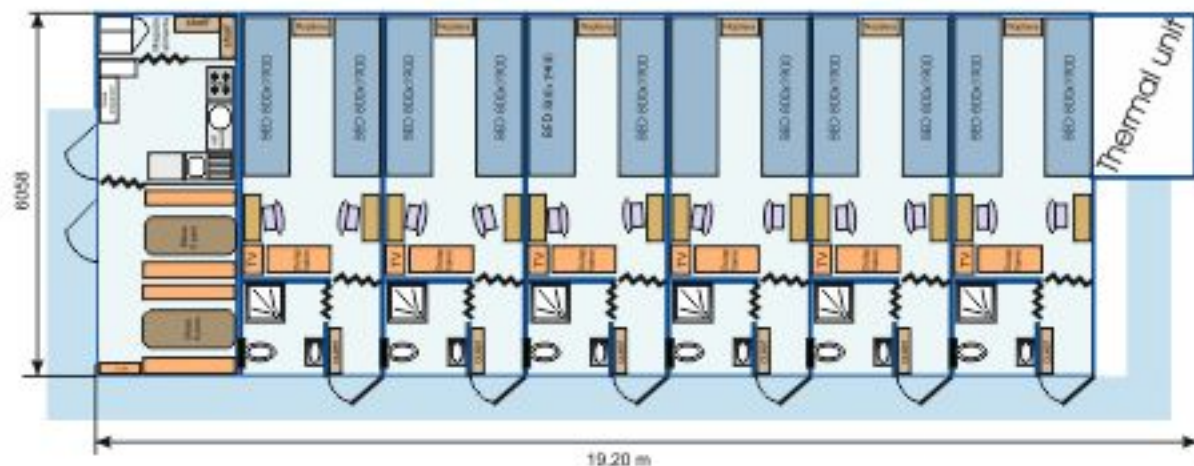









 **CONFIND**
www.confind.ro

Str. Progresului nr. 2, Câmpina105600, jud. Prahova, România
Tel/Fax: +40 244 37.47.19; +40 244 37.37.09; +40 244 33.31.60
e-mail: confind@Confind.ro